

## GRASS + GROUND COVER MIXES

	NAME	SIZE	QTY	m <sup>2</sup>
<b>A</b>	<i>Themeda triandra</i>	Virocell	4	12/m <sup>2</sup>
	<i>Austrodanthonia caespitosa</i>	Virocell	4	12/m <sup>2</sup>
	<i>Poa sieberiana</i>	Virocell	4	12/m <sup>2</sup>
	NAME	SIZE	QTY	m <sup>2</sup>
<b>B</b>	<i>Carex appressa</i>	Virocell	4	12/m <sup>2</sup>
	<i>Juncus filicaulis</i>	Virocell	4	12/m <sup>2</sup>
	<i>Scirpus nodosus</i>	Virocell	4	12/m <sup>2</sup>
	NAME	SIZE	QTY	m <sup>2</sup>
<b>C</b>	<i>Microlaena stipoides</i>	Virocell	4	12/m <sup>2</sup>
	<i>Wahlenbergia stricta</i>	Virocell	4	12/m <sup>2</sup>
	<i>Aristida ramosa</i>	Virocell	4	12/m <sup>2</sup>
	NAME	SIZE	QTY	m <sup>2</sup>
<b>D</b>	<i>Calocephalus citreus</i>	Virocell	4	16/m <sup>2</sup>
	<i>Chrysocephalum apiculatum</i>	Virocell	4	16/m <sup>2</sup>
	<i>Leucochrysum albicans</i>	Virocell	4	16/m <sup>2</sup>
	<i>Craspedia variabilis</i>	Virocell	4	16/m <sup>2</sup>
	NAME	SIZE	QTY	m <sup>2</sup>
<b>E</b>	<i>Doodia aspera</i>	140mm	4	6/m <sup>2</sup>
	<i>Viola hederacea</i>	140mm	4	3/m <sup>2</sup>
	NAME	SIZE	QTY	m <sup>2</sup>
<b>F</b>	<i>Austrostipa scabra</i>	Virocell	4	12/m <sup>2</sup>
	<i>Aristida ramosa</i>	Virocell	2	12/m <sup>2</sup>
	<i>Geranium solanderi</i>	Virocell	4	12/m <sup>2</sup>
	<i>Hibbertia obtusifolia</i>	Virocell	2	12/m <sup>2</sup>
	NAME	SIZE	QTY	m <sup>2</sup>
<b>G</b>	<i>Scirpus nodosus</i>	Virocell	4	8/m <sup>2</sup>
	<i>Lomandra multiflora</i>	Virocell	4	8/m <sup>2</sup>



Themeda triandra    Austrodanthonia caespitosa    Poa sieberiana



Carex appressa    Juncus filicaulis    Scirpus nodosus



Microlaena stipoides    Aristida ramosa    Wahlenbergia stricta



Calocephalus citreus    Chrysocephalum apiculatum    Leucochrysum albicans    Craspedia variabilis



Doodia aspera    Viola hederacea



Austrostipa scabra    Aristida ramosa    Geranium solanderi    Geranium solanderi    Hibbertia obtusifolia



Scirpus nodosus    Lomandra multiflora

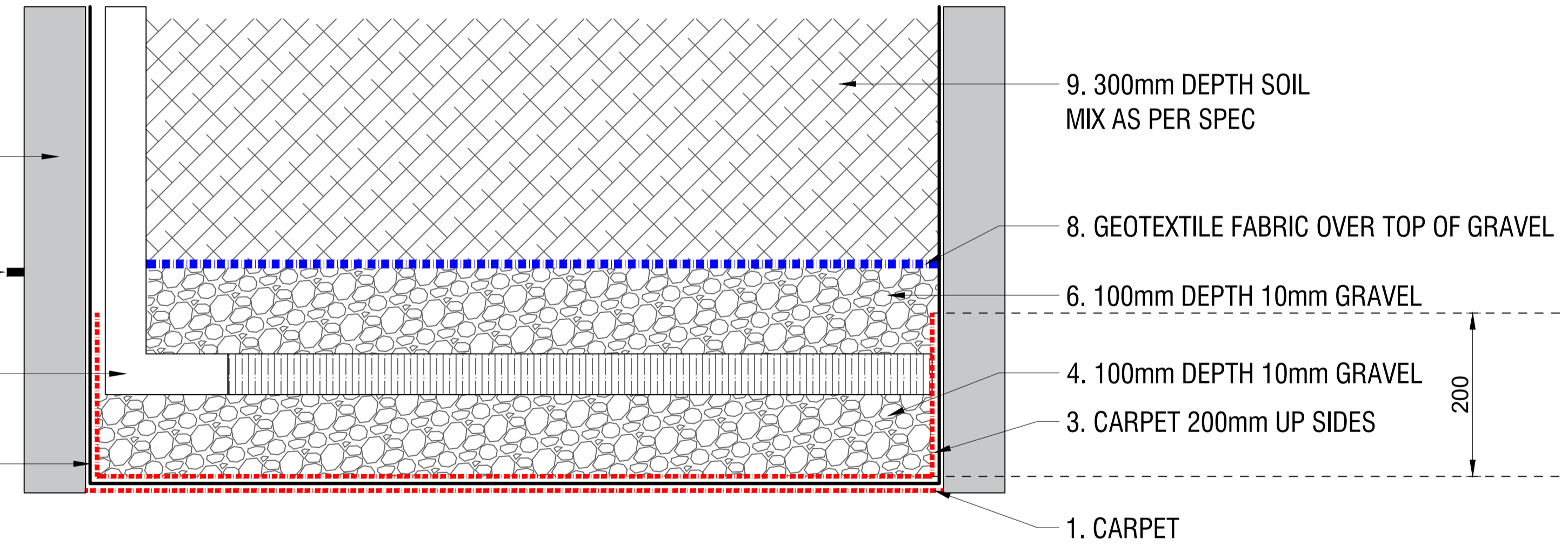

CONCRETE SLEEPER

7. WHERE GRAVEL MEETS THE SOIL  
DRILL AN OVERFLOW HOLE

5. UPRIGHT PVC PIPE CONNECTED TO  
AG DRAIN COILED AROUND BOTTOM OF BED

2. BLACK PLASTIC

### 'WICKING' VEGETABLE GARDEN DETAIL 1:10@A3

REV.	DESCRIPTION	DRAWN	APPROVED	DATE
A	DRAFT	HJ	NH	13JUL21
-	-	-	-	-
-	-	-	-	-
-	-	-	-	-
-	-	-	-	-
-	-	-	-	-
-	-	-	-	-
-	-	-	-	-
-	-	-	-	-
-	-	-	-	-

**HARRIS HOBBS** Landscape Architect  
**LANDSCAPES**  
 16 ROBE STREET  
 DEAKIN ACT 2600  
 p +61 2 6273 4661  
 e hh@hhl.com.au  
 w www.hhl.com.au

Harris Hobbs Landscapes acknowledges the Ngurrnawal people, the traditional custodians of the land on which we live, work, rest and play.

SCALE @ A1  
NTS

DATE  
JULY 2021

PROJECT  
WALK ST, GUNGAHLIN

CLIENT  
NAME

DRAWING TITLE  
DETAILS

STATUS **DRAFT**

JOB **21143**

REV **A**

DWG **401**